

How To Measure Roller Chain

The most important roller chain dimensions to measure is the Pitch (P), Roller Diameter (d1) and Inner Width (b1). These three dimension will help you determine what roller chain size you have. Below are the roller chain size charts for single, double and triple strand ANSI roller chain. The last chart is for single strand metric (British Standard) roller chain. You can also look at the side plates as most chain manufacturers stamp the chain size in.

Single Strand ANSI Roller Chain Size Chart

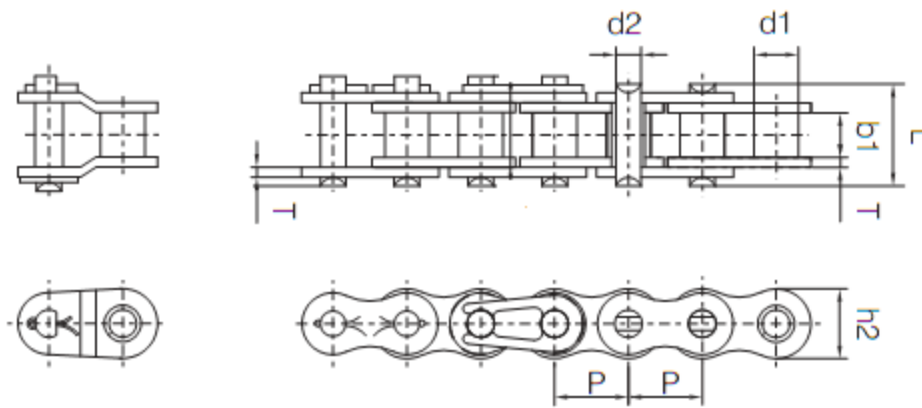

Chain Number	Pitch	Roller Width	Roller Diameter	Overall Width	Pin Diameter	Plate Height	Plate Thickness	Average Tensile Strength
-	P	b1	d1	L	d2	h2	T	LBS
25-1*	1/4	1/8	0.130	0.311	0.091	0.228	0.030	1,000
35-1*	3/8	3/16	0.200	0.488	0.141	0.346	0.050	2,400
40-1	1/2	5/16	0.312	0.653	0.156	0.469	0.060	3,900
41-1	1/2	1/4	0.306	0.541	0.141	0.390	0.050	2,833
50-1	5/8	3/8	0.400	0.815	0.200	0.585	0.080	6,600
60-1	3/4	1/2	0.469	1.020	0.234	0.709	0.094	9,300
80-1	1	5/8	0.625	1.287	0.312	0.949	0.125	15,600
100-1	1-1/4	3/4	0.750	1.590	0.375	1.188	0.156	24,500
120-1	1-1/2	1	0.875	1.980	0.437	1.425	0.187	35,100
140-1	1-3/4	1	1.000	2.141	0.500	1.663	0.219	47,600
160-1	2	1-1/4	1.125	2.551	0.562	1.889	0.250	62,700
180-1	2-1/4	1-13/32	1.406	2.866	0.687	2.047	0.281	76,800
200-1	2-1/2	1-1/2	1.562	3.161	0.781	2.375	0.312	97,000
240-1	3	1-7/8	1.875	3.760	0.937	2.791	0.375	139,900



Single Strand Metric (British Standard) Roller Chain Size Chart

Chain Number	Pitch	Roller Width	Roller Diameter	Overall Width	Pin Diameter	Plate Height	Plate Thickness	Average Tensile Strength
-	P	b1	d1	L	d2	h2	T	LBS
04B	0.236	0.110	0.157	0.268	0.072	0.196	0.023	719
05B	0.315	0.197	0.196	0.350	0.090	0.280	0.030	1,300
06B	3/8	0.225	0.250	0.531	0.130	0.335	0.050	2,300
08B	1/2	0.305	0.335	0.669	0.175	0.472	0.060	4,000
10B	5/8	0.380	0.400	0.772	0.200	0.579	0.065	5,600
12B	3/4	0.460	0.475	0.894	0.225	0.639	0.070	7,200
16B	1	0.670	0.625	1.421	0.326	0.827	0.156	15,000
20B	1-1/4	0.770	0.750	1.701	0.401	1.039	0.177	23,800
24B	1-1/2	1.000	1.000	2.102	0.576	1.315	0.238	40,000
28B	1-3/4	1.220	1.100	2.563	0.625	1.444	0.275	49,900
32B	2	1.220	1.150	2.654	0.701	1.661	0.276	62,300

