

FORGED CHAINS



HEADQUARTERS 514.886.5270

12985 Rue Brault, Mirabel Quebec, Canada J7J 0W2

UNIKINGCANADA.COM

Drop Forged Chain

Drop forged chain is made of special heat treated alloy steel, case hardened to rockwell C57-C62 with a ductile core hardness of rockwell C40. Superior heat treatment technique provides the optimum chain link with a more resilient ductile core for shock resistance, and an extremely hard exterior surface for superior wear resistance. Uniking is backed by an international network of companies with over 150 years of experience, and a global team of engineers and sales professionals that can provide you with practical solutions for all your material handling applications.

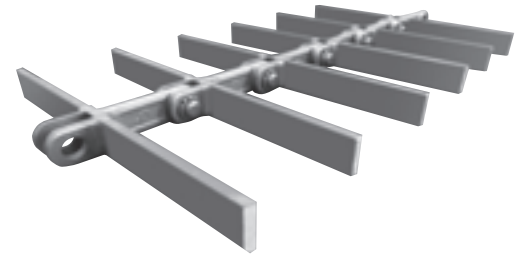

STANDARD LINK



BOLT 'N' GO LINK



Links and pins are available in stainless steel

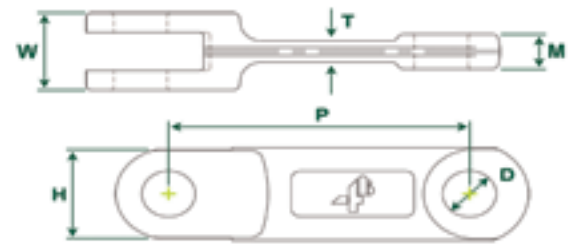

Standard Link

Chain Link	Min Breaking Load (kN)	Case Hardness	Case Depth (mm)	Core Hardness	Weight (Per Link) (kg)	Bolt 'N' Go Compatible	Dimensions					
							P (mm)	H (mm)	T (mm)	W (mm)	M (mm)	D (mm)
102LA	150	Rockwell C57-C62	0.5	Rockwell C40	0.36	No	102	36	6	25	8	14
102NA	180	Rockwell C57-C62	0.5	Rockwell C40	0.38	Yes	102	36	7	28	12	14
125NA	200	Rockwell C57-C62	0.6	Rockwell C40	0.70	Yes	125	35	10	36	15	16
142LA	250	Rockwell C57-C62	0.7	Rockwell C40	0.66	No	142	40	10	31	14	18.2
142NA	300	Rockwell C57-C62	0.7	Rockwell C40	1.08	Yes	142	50	12	42	18.7	25
142HA	450	Rockwell C57-C62	0.7	Rockwell C40	1.76	Yes	142	50	16.5	62	28.5	25
150NA	300	Rockwell C57-C62	0.7	Rockwell C40	1.20	Yes	150	49	13	36	15	25
160NA	350	Rockwell C57-C62	0.8	Rockwell C40	1.30	Yes	160	44.5	13	42	19.5	20
175NA	520	Rockwell C57-C62	1.0	Rockwell C40	2.73	No	175	60	16	72	22	30
200NA	600	Rockwell C57-C62	1.0	Rockwell C40	2.85	No	200	60	18	68	30	30
216NA	600	Rockwell C57-C62	1.0	Rockwell C40	3.66	No	216	75	19	59	26	35
250NA	700	Rockwell C57-C62	1.0	Rockwell C40	4.26	No	250	75	18	70	32	32
260NA	700	Rockwell C57-C62	1.0	Rockwell C40	5.38	No	260	75	21	71	31	32



DOUBLE & TRIPLE LINKS

Double and triple links are forged with the same quality, strength and durability as our standard links.

DOUBLE LINK

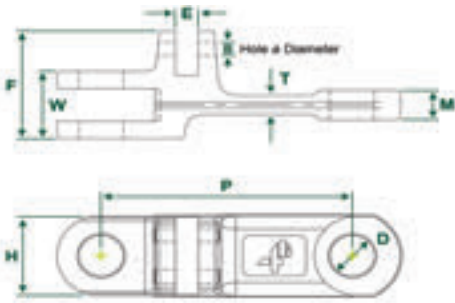

TRIPLE LINK

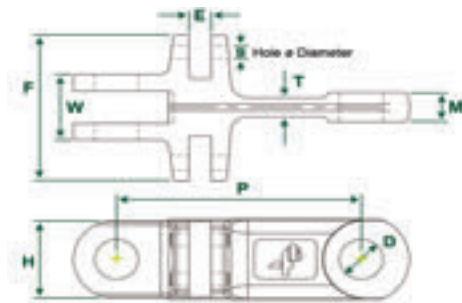

Typical Double Strand Chain Application

Triple Configuration

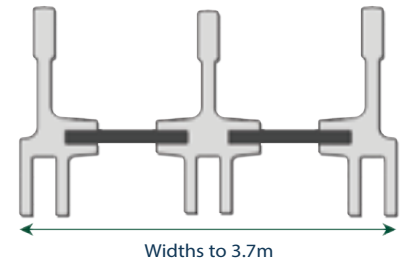

Chain Link	Min Breaking Load (kN)	Case Hardness	Case Depth (mm)	Core Hardness	Weight (Per Link) (kg)	Bolt 'N' Go Compatible	Dimensions								
							P (mm)	H (mm)	T (mm)	W (mm)	M (mm)	D (mm)	F (mm)	E (mm)	B (mm)
142DNA	300	Rockwell C57-C62	0.7	Rockwell C40	1.37	No	142	50	12	42	18.7	25	67	13	8.5
142DHA	450	Rockwell C57-C62	0.7	Rockwell C40	2.00	No	142	50	16	62	28	25	87	13	8.5
142TNA	300	Rockwell C57-C62	0.7	Rockwell C40	1.67	No	142	50	12	42	18.7	25	92	13	8.5
142THA	450	Rockwell C57-C62	0.7	Rockwell C40	2.32	No	142	49	16	62	28.5	25	112	13	8.5

Other sizes available on request.



HEADQUARTERS 514.886.5270

12985 Rue Brault, Mirabel Quebec, Canada J7J 0W2

UNIKINGCANADA.COM

Typical Welded Flight Attachments



Square Bar Flight



Flat Bar Flight



Paddle Flight



U Flight



Closed U Flight



Closed U Flights with Filler Plates



00 Flight

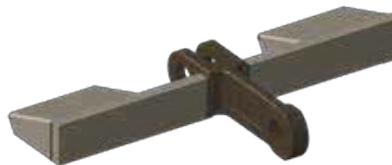

Return Cups

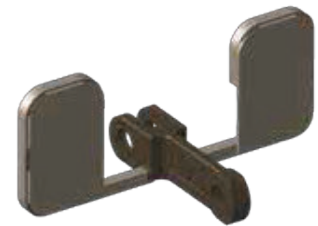

00 Flight with Filler Plates

Note: Custom flights are available, based on customer specifications.

Standard Pin Options

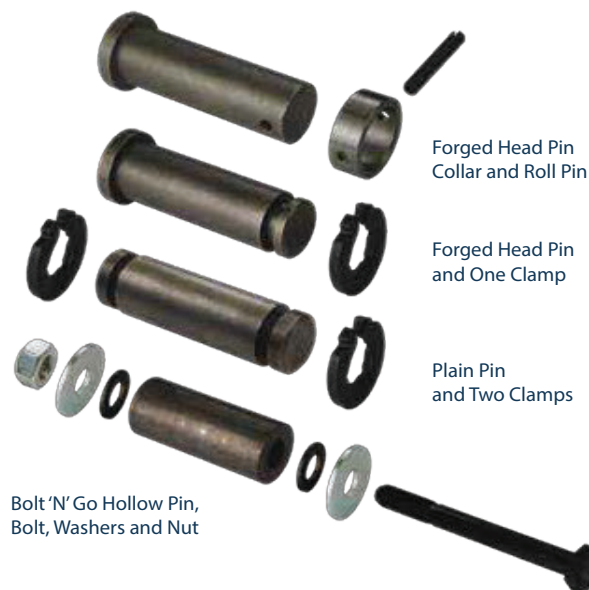

Forged Head Pin Collar and Roll Pin

Forged Head Pin and One Clamp

Plain Pin and Two Clamps

Bolt 'N' Go Hollow Pin, Bolt, Washers and Nut

Bolt 'N' Go

Bolt 'N' Go flight system is a revolutionary assembly method for drop forged. Link and flight assembly is made easy by using a standard bolt and mechanical lock nut with a high strength hollow pin. There are no circlips and no intricate assembly required. There is no welding of flights, no need to remove chain from the conveyor for installation, and no issues with strength. Just bolt the links and the flights together. It's easy, simple and reliable!

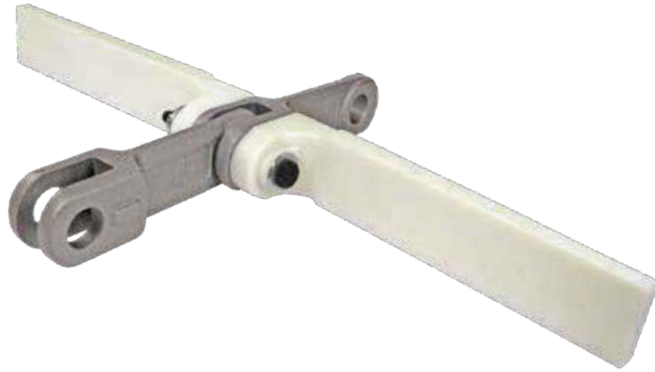

Bolt 'N' Go Link



Bolt 'N' Go System

Detailed View of Bolt 'N' Go
Showing Assembly Method

US Pat. 7,080,728
Canadian Pat. 2,548,660
Mexican Pat. 272,056
Other Patents Pending

Sprockets

Sprockets and trailers are manufactured from high grade heat treated steel to a minimum hardness of 57 HRC. Each piece is machined to size with appropriate bore and keyway specific to each customer's application. Most sizes are in stock and ready to ship from inventory.



Standard Sprocket
(Shown with hub)

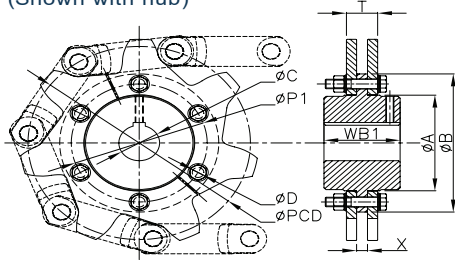

Wear Reversible Sprocket
(Shown with hub)

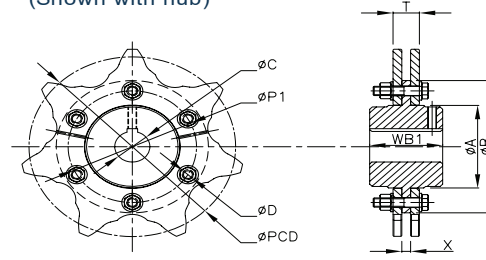

Chain Link	No. of Teeth	Pitch Circle Dia ØPCD (mm)	ØP1 (mm)	ØA (mm)	ØB (mm)	ØC max, Sprocket/ Stub Trailer (mm)	ØD (mm)	No. of Bolts	T (mm)	X (mm)	WB1 (mm)
4B102NA	6	204.0	-	105.0	135.0	70	-	-	30	10	83
	7	235.1	146.0	108.0	173.0	70	M12	6	30	10	83
	8	266.5	170.0	144.0	196.0	85	M12	6	30	10	83
	9	298.2	200.0	174.0	232.0	105	M12	6	30	10	83
	10	330.1	241.3	179.0	264.0	105	M12	8	30	10	83
4B142NA	6	284.0	168.3	136.5	190.5	85	M12	6	46	16	112
	7	327.3	200.0	162.0	234.0	105	M16	6	46	16	112
	8	371.1	241.3	187.3	282.0	115	M20	8	46	16	127
	9	415.2	285.8	240.0	330.0	150	M20	8	46	16	127
	10	459.5	285.8	240.0	330.0	150	M20	8	46	16	127
	11	504.0	368.3	310.0	419.0	170	M20	8	46	16	150
	12	548.6	415.0	345.0	465.0	170	M20	8	46	16	150
	13	593.4	450.0	380.0	521.0	170	M20	8	46	16	150
4B142HA	7	327.3	200.0	162.0	234.0	105	M16	6	69	19	127
	8	371.1	241.3	187.3	282.0	115	M20	8	69	19	150
	9	415.2	285.8	240.0	330.0	150	M20	8	69	19	150
	10	459.5	285.8	240.0	330.0	150	M20	8	69	19	150
	11	504.0	368.3	310.0	419.0	170	M20	8	69	19	150
	12	548.6	415.0	345.0	465.0	170	M20	8	69	19	150
	13	593.4	450.0	380.0	520.0	170	M20	8	69	19	180
14	638.1	470.0	380.0	546.0	170	M20	10	69	19	180	

Bore and keyway to customer specification. Sprockets and trailers available for all chain sizes. Contact Uniking for more information.



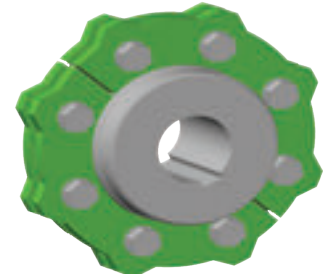

Trailers

Segmental Stub Trailer
(Shown with hub)

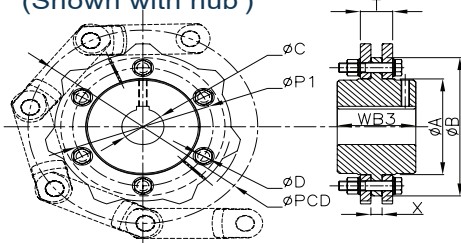

Asymmetric Smooth Trailer**

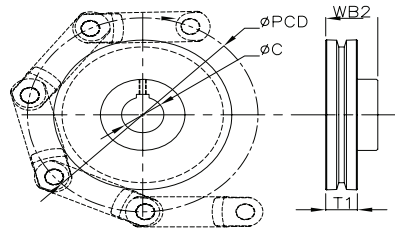

Chain Link	ØC max Smooth Trailer (mm)	Pitch Circle Dia. ØPCD (mm)	Hub Width* (mm)		Rim Width T1 (mm)
			Smooth WB2	Segmental WB3	
4B102NA	65	204.0	57	83	35
	65	235.1	57	83	35
	65	266.5	57	83	35
	65	298.2	57	83	35
	65	330.1	57	83	35
4B142NA	85	284.0	74	112	45
	85	327.3	74	112	45
	85	371.1	77	127	45
	115	415.2	77	127	45
	115	459.5	77	127	45
	115	504.0	105	150	45
	115	548.6	105	150	45
	115	593.4	120	150	45
4B142HA	115	327.3	110	127	75
	115	371.1	110	150	75
	115	415.2	110	150	75
	115	459.5	120	150	75
	140	504.0	120	150	75
	140	548.6	120	150	75
	140	593.4	120	150	75
	140	638.1	140	150	75

* Smooth and segmental trailers have different hub widths as noted (WB2 & WB3).

** Symmetric smooth trailers on demand.

Additional Recommendation

1. Sprocket cleaners and chain wipers help maintain the sprocket clear of buildup for the chain to engage.
2. Conveyor inlet screens ensure that particle size does not exceed conveyor design parameters and help prevent tramp material from entering the conveyor.
3. Conveyor inlet magnets help prevent the introduction of tramp material.
4. Central rails made from Hadfield manganese steel will maximize chain life and help prevent fatigue on welded flights (Image E).
5. Wear bushings, AR steel flights, and hard weld coatings are available for extremely abrasive applications.
6. For installation assistance or any application questions, call Uniking Canada.

IMAGE E
Manganese Rail
to Support Chain

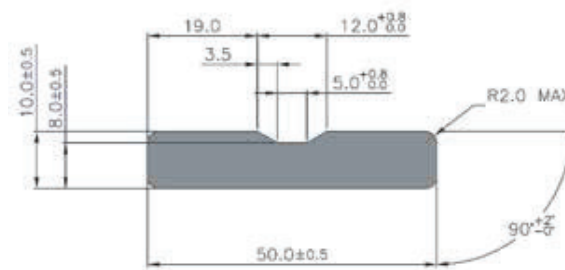
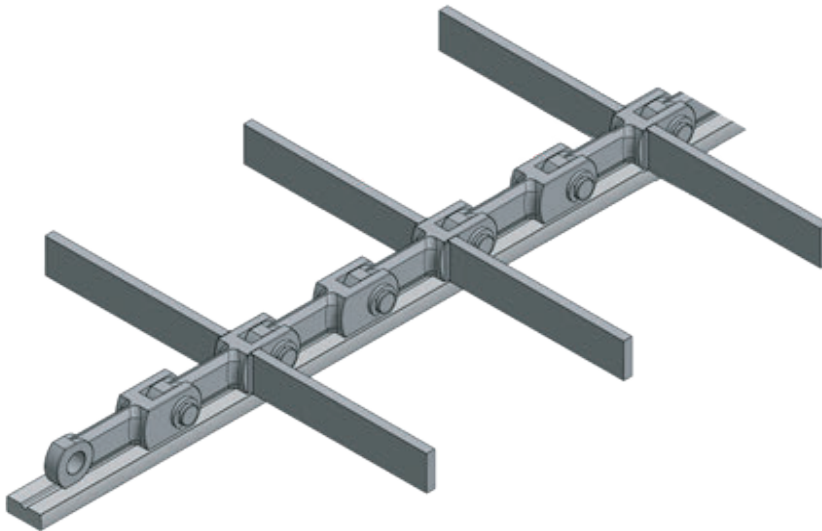

Rail Design for 142NA Chain